

TMX ET05

SAW Bandpass Filter - RF
Preliminary Specification (Rev 1)

▣ Features	P01
▣ Package Drawing	P01
▣ Technical Characteristics	P02
▣ Matching Network	P02
▣ Nominal Response	P03
▣ Maximum Ratings	P04
▣ Marking & Packaging	P04

TMX ET05

SAW Bandpass Filter – Remote Control - RF

Preliminary Specification (Rev 1)

February 17th, 2011

Features

- ❑ RF SAW Filter
- ❑ 866 MHz Center Frequency
- ❑ Ceramic package for Surface Mounted Technology
- ❑ RoHS Compliant

Package Drawing & Pin out

The product is in conformance with the European RoHs Regulation 2002/95.

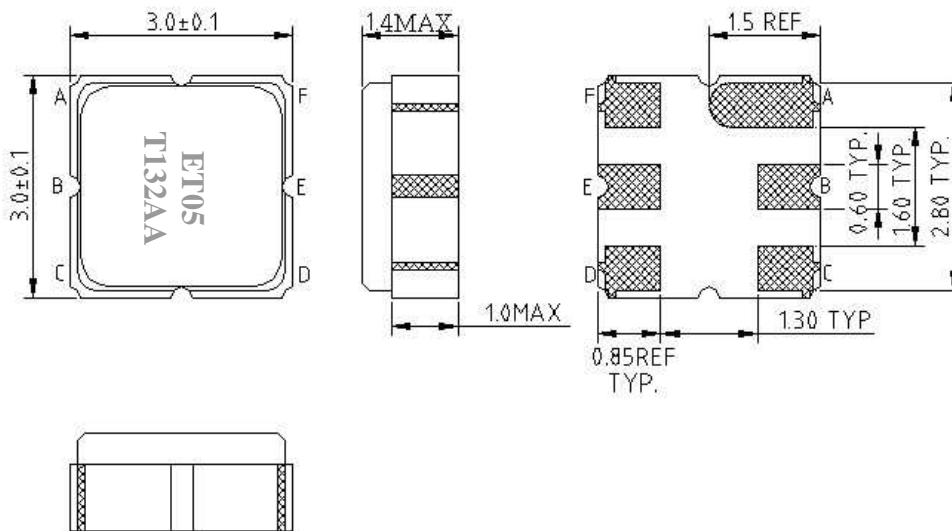

Pin Configuration	
B	Input
E	Output
A,C, D,F	Ground

TMX ET05

SAW Bandpass Filter – Remote Control - RF

Preliminary Specification (Rev 1)

February 17th, 2011

Technical Characteristics

Reference Temperature : +25°C

Electrical Parameters	Unit	Minimum	Typical ⁽¹⁾	Maximum
Center Frequency fo	MHz		866	
Insertion Loss at fo	dB	-	2.3	3.0
Ripple (863 ~ 870 MHz)	dB	-	0.3	1.3
VSWR (863 ~ 870 MHz)	μsec	-	1.2	2.0
Relative Attenuation (Relative to IL)				
From 10 MHz to 830 MHz	dB	45	49	-
From 830 MHz to 850 MHz	dB	22	35	-
From 885 MHz to 905 MHz	dB	27	35	-
From 905 MHz to 950 MHz	dB	45	49	-
From 950 MHz to 1500 MHz	dB	40	47	-
From 1500 MHz to 3000 Mhz	dB	25	28	-
Package type & size				
Length x Width	mm		3.0 x 3.0	
Height	mm			1.4
Pin Out				
Input	B		Output	E
Case Ground	A,C,D, F		To be grounded	A,C,D, F

Notes :

(1) Typical values are nominal performances at room temperature

Measurement Circuit

HP Network analyzer

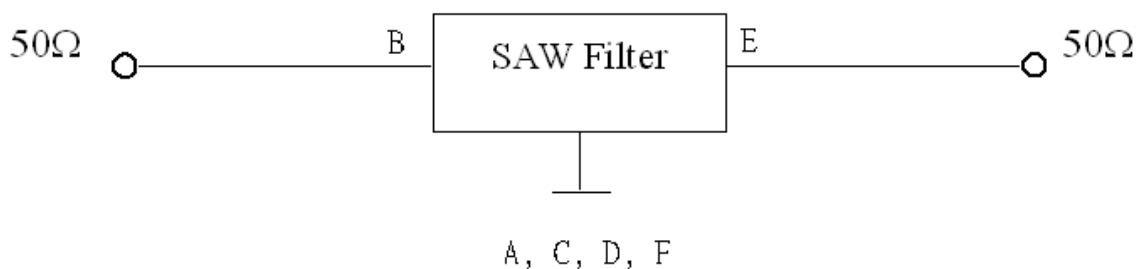

TMX ET05

SAW Bandpass Filter – Remote Control - RF

Preliminary Specification (Rev 1)

February 17th, 2011

Nominal Frequency Response (Simulations)

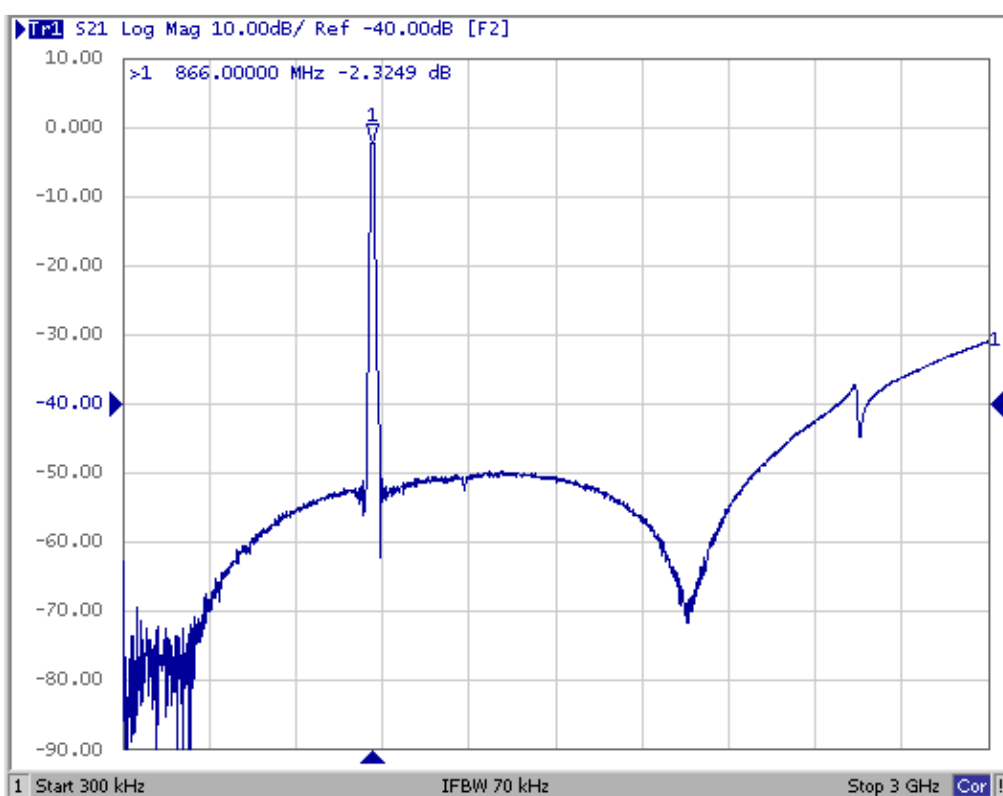
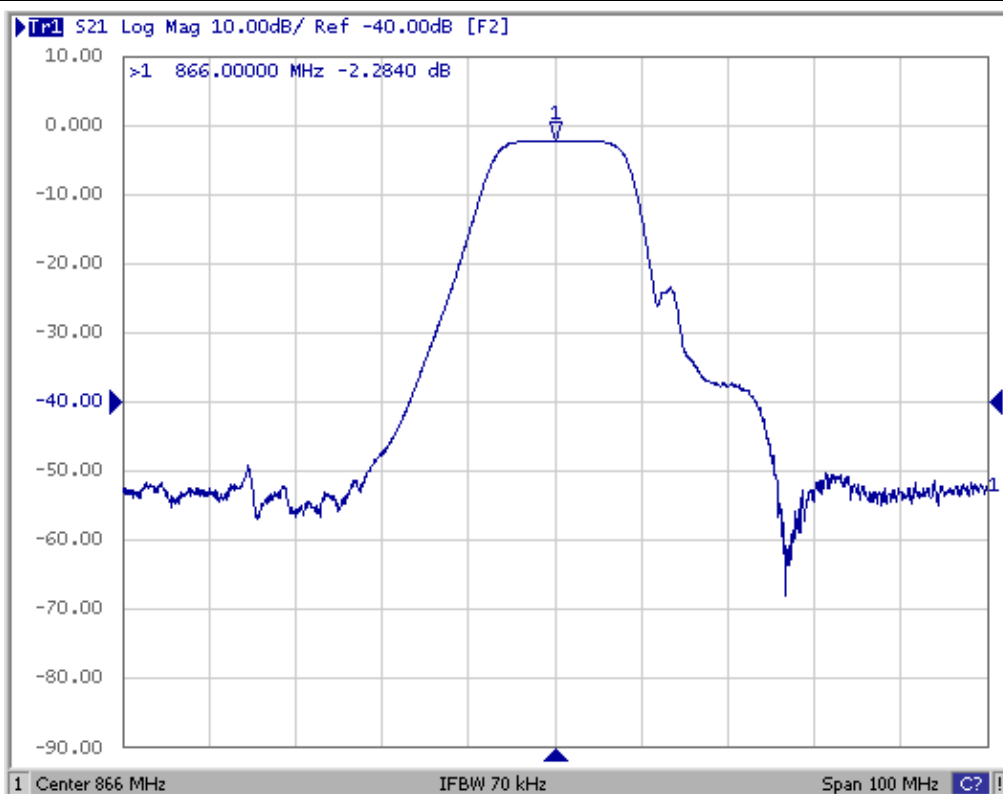

Maximum Ratio

TMX ET05

SAW Bandpass Filter – Remote Control - RF

Preliminary Specification (Rev 1)

February 17th, 2011

Storage Temperature Range	°C	[-30°C ; +85°C]
Operating temperature	°C	[-25°C ; +70°C]
DC voltage	V	3
Input Power Level	dBm	18

Marking

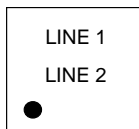

Line 1: "NNNN" is the reference to Temex Part number with only the last 4 digits

Line 2: TYWWZZ is the date code as:

T: Partner identifier.

Y: last digit of the year.

WW: number of week in the year

ZZ: Lot number in the week (from AA to ZZ).

Packaging

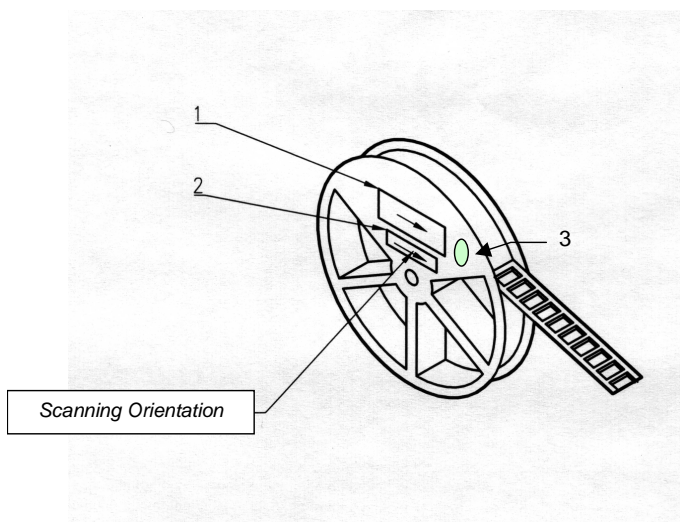

3Kpcs/reel

- 1 – Rakon Temex Label
- 2 – ESD Prevention Label
- 3 – Pb Free Label